

No.	PART NAME	QTY	MATERIAL
1	HOUSING	1	PC/ABS
2	SLEEVE HOLDER	1	PBT
3	SLEEVE	1	ZIRCONIA
4	CLIP	1	SUS304
5	CAPS(FS03)	2	PBT

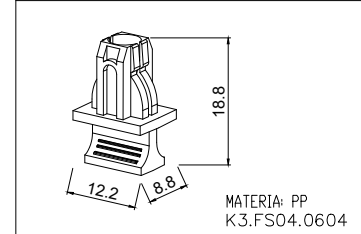

OPTIONAL ATTACHMENT

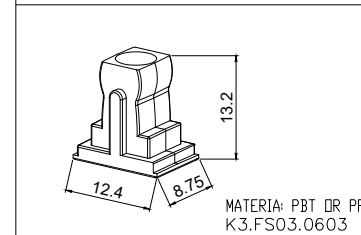
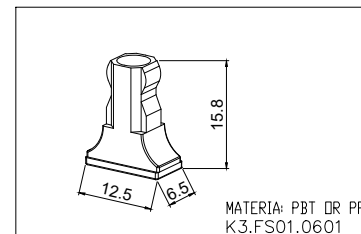
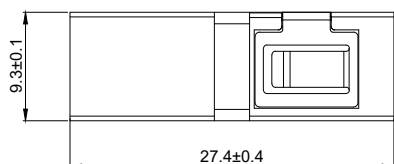
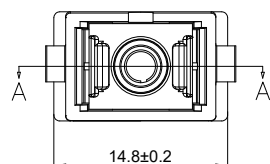
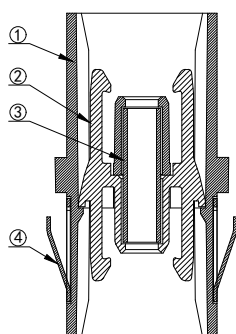
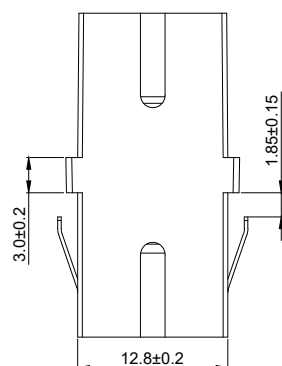
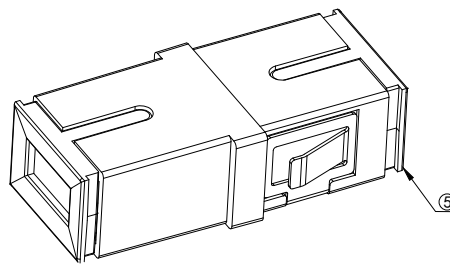

SECTION A-A

- TECHNICAL REQUIREMENT:  
 1.COMPLIES WITH IEC 61754-4 AND TIA-604-3  
 2.COMPLIES WITH IEC-60874-14-3 AND IEC-60874-14-4  
 3.COMPLIES WITH IEC 61753-1 CATEGORY (C)  
 4.COMPLIES WITH ROHS, REACH REQUIREMENTS

NOTES  
 1.ALL DIMENSIONS WITHOUT TOLERANCE ARE FOR REFERENCE ONLY.  
 2.DUST CAPS ARE SHOWN IN ISOMETRIC VIEWS ONLY.

DIMENSION UNITS	SCALE	CURRENT REV DESC:	
MM	1:1		
GENERAL TOLERANCES (UNLESS SPECIFIED)			
ANGULAR TOL ± °			
X	± 0.2	DRWN: JHK	2024/05/12
X.X	± 0.1	CHK'D: CHENEY	2024/05/13
X.XX	± 0.05	APPR: JACK	2024/12/03
X.XXX	± 0.003	INITIAL REVISION:	
X°	± 2°	DRWN: CHENEY	2022/04/01
X.X°	± 1°	APPR: JACK	2022/04/27
DRAFT WHERE APPLICABLE MUST REMAIN WITHIN DIMENSIONS		THIRD ANGLE PROJECTION	DRAWING CUSTOMER
			A-SIZE 0029



SC SIMPLEX ADAPTER-WITHOUT FLANGE-(INTEGRATED)

PRODUCT DRAWING

DOCUMENT NUMBER	DOC TYPE	DOC PART	DREVISION
K2.SC1010.0029	PDF	A001	A/2
MATERIAL NUMBER	CUSTOMER	SHEET NUMBER	
SEE TABLE	GENERAL MARKET	1 OF 1	